

**Demonstrate Inspecting and Servicing Various Bearing, Seal and Gasket Used in Heavy Equipment**

Skill Number CO-OP15GN106

Full Name: Aloysius Chaka S.O

No ID: \_\_\_\_\_

Validation Date: \_\_\_\_\_ School: \_\_\_\_\_

**PERFORMANCE TASK:**

Given assorted bearings, seals and gaskets, the student is requested to perform the following tasks on the components:

- Removing
- Inspection
- Installing

The student must be able to perform the following task:

- Demonstrate removing, inspection and installing Bearing, Seals and Gasket.

It is recommended that assessor put questions to student regarding the findings of their inspections and subsequent report. Literature and measuring tools will be made available but will not be provided directly to the student.

Safety and Contamination Control must be always applied to this process.

| Prerequisite   | Yes | No | N/A | Hints |
|--|-----|----|-----|-------|
| The student must complete the knowledge assessment. Minimum passing grade 80%. |     |    |     |       |

| Tasks  | Completed |    |     | Observation / Hints |
|--|-----------|----|-----|---------------------|
|  | Yes       | No | N/A |                     |
| Preparation                                      |           |    |     |                     |
| Prepare related literature                       |           |    |     |                     |
| Prepare required equipment                       |           |    |     |                     |
| Prepare related tools                            |           |    |     |                     |
| Prepare Safety & Contamination Control equipment |           |    |     |                     |

| Tasks  | Completed |    |     | Observation / Hints |
|--|-----------|----|-----|---------------------|
|  | Yes       | No | N/A |                     |
| Perform etiquette/manner when starting the job         |           |    |     |                     |
| Meet the customer / assessor                           |           |    |     |                     |
| Perform etiquette/manner when opening the interaction. |           |    |     |                     |
| Explain the purpose of Student's activity.             |           |    |     |                     |
| Ask permission to perform the job.                     |           |    |     |                     |

| Tasks   | Completed |    |     | Observation / Hints |
|---|-----------|----|-----|---------------------|
|   | Yes       | No | N/A |                     |
| Remove, Inspect and Install Bearings, Seals and Gaskets                   |           |    |     |                     |
| 1. Accessing Information  |           |    |     |                     |
| 2. Bearing, Seals & Gasket Removal  |           |    |     |                     |
| 3. Delineate bearing reusability of bearings, seals, and gasket           |           |    |     |                     |
| 4. Bearing, Seals & Gasket Installation                                   |           |    |     |                     |
| 5. Equipment and tooling are used in the correct way                      |           |    |     |                     |
| 6. Equipment and tooling are cleaned and returned to its correct location |           |    |     |                     |
| Documentation:  |           |    |     |                     |
| Take picture if needed  |           |    |     |                     |

| Tasks  | Completed |    |     | Observation / Hints |
|--|-----------|----|-----|---------------------|
|  | Yes       | No | N/A |                     |
| Perform close the job by ensuring all systems or conditions is in the standard condition |           |    |     |                     |
| Ensure all systems or conditions are in standard condition.                              |           |    |     |                     |

| Reporting  | Completed |    |     | Observation / Hints |
|--|-----------|----|-----|---------------------|
|  | Yes       | No | N/A |                     |
| All relevant documentation completed correctly and approved by customer (if required). |           |    |     |                     |

| Tasks   | Completed |    | Observation / Hints |
|---|-----------|----|---------------------|
|   | Yes       | No |                     |
| Safety  |           |    |                     |
| Using APD related to the job  |           |    |                     |
| Follows relevant Workplace Safety Guidelines (LOTO, Safety Equipment)                   |           |    |                     |
| State and follow Safety Precautions   |           |    |                     |
| Service man completes job without accident due to incorrect procedure using hand tools. |           |    |                     |
| Tasks completed without damage equipment and tools                                      |           |    |                     |

| Tasks                                  | Completed |    | Observation / Hints |
|--|-----------|----|---------------------|
|  | Yes       | No |                     |
| Contamination Control                  |           |    |                     |
| Environmental Practices & Housekeeping |           |    |                     |

| Tasks  | Completed |    |     | Observation / Hints |
|--|-----------|----|-----|---------------------|
|  | Yes       | No | N/A |                     |
| Perform etiquette/manner after completing the job        |           |    |     |                     |
| Perform etiquette/manner when closing the communication. |           |    |     |                     |

General Comments

\_\_\_\_\_  
 \_\_\_\_\_  
 \_\_\_\_\_

RESULT: **COMPETENT**  **NOT YET COMPETENT**  (please check (✓))

Student: Aloysius Chika S.O Date: 9/01/2026

Assessor: Sebastian Tis Date: 9/1/2026  
 Signature: 

Supervisor: \_\_\_\_\_ Name \_\_\_\_\_ Date \_\_\_\_\_ Signature \_\_\_\_\_

Data Recorded: \_\_\_\_\_ Name \_\_\_\_\_ Date \_\_\_\_\_ Signature \_\_\_\_\_

**Demonstrate Inspecting and Servicing Various Bearing, Seal and Gasket Used in Heavy Equipment**

Skill Number CO-OP15GN106

Full Name: Aloysius Chales S.D No ID: \_\_\_\_\_  
 Validation Date: 9/1/2025 School: \_\_\_\_\_

**PERFORMANCE TASK:**

Given assorted bearings, seals and gaskets, the student is requested to perform the following tasks on the components:

- Removing
- Inspection
- Installing

The student must be able to perform the following task:

- Demonstrate removing, inspection and installing Bearing, Seals and Gasket.
- It is recommended that assessor put questions to student regarding the findings of their inspections and subsequent report. Literature and measuring tools will be made available but will not be provided directly to the student. Safety and Contamination Control must be always applied to this process.

| Prerequisite   | Completed |    |     | Hints  |
|--|-----------|----|-----|--|
|  | Yes       | No | N/A |  |
| The student must complete the knowledge assessment. Minimum passing grade 80%. | ✓         |    |     | Score seal, bearing, gasket course or subject. |

| Tasks  | Completed |    |     | Observation / Hints  |
|--|-----------|----|-----|--|
|  | Yes       | No | N/A |  |
| Prepare related literature                       | ✓         |    |     | Observe if the candidate is referring to the Manufacturer's Literature   |
| Prepare required equipment                       | ✓         |    |     | Observe if the candidate is preparing bearings, seals, and gaskets   |
| Prepare related tools                            | ✓         |    |     | Observe if the candidate is preparing related tools (e.g.: Hand tools, bearing puller, Bearing heater, Infrared Thermometer, etc.) |
| Prepare Safety & Contamination Control equipment | ✓         |    |     | Observe if the candidate is preparing related Safety & CC Equipment (e.g.: PPE, Blue Towel, Plastic Wrap, etc.)                    |



| Tasks  | Completed |    |     | Observation / Hints                                   |
|--|-----------|----|-----|---|
|  | Yes       | No | N/A |   |
| <b>Perform etiquette/manner when starting the job</b>  | ✓         |    |     |   |
| Meet the customer / assessor                           | ✓         |    |     |   |
| Perform etiquette/manner when opening the interaction. | ✓         |    |     | • Perform smile & greet<br>• Introduce Student's name |
| Explain the purpose of Student's activity.             | ✓         |    |     |   |
| Ask permission to perform the job.                     | ✓         |    |     |   |

| Tasks   | Completed |    |     | Observation / Hints   |
|---|-----------|----|-----|---|
|   | Yes       | No | N/A |   |
| <b>Remove, Inspect and Install Bearings, Seals and Gaskets</b>            |           |    |     |   |
| 1. Accessing Information  | ✓         |    |     | Observe if the candidate is accessing information relating task from manual literature                  |
| 2. Bearing, Seals & Gasket Removal  | ✓         |    |     | Observe if the candidate is removing seals and gasket following instruction manufacturer's literature   |
| 3. Determine bearing reusability of bearings, seals, and gasket           | ✓         |    |     | Observe if the candidate is inspecting seals and gasket following instruction manufacturer's literature |
| 4. Bearing, Seals & Gasket Installation                                   | ✓         |    |     | Observe if the candidate is installing seals and gasket following instruction manufacturer's literature |
| 5. Equipment and tooling are used in the correct way                      | ✓         |    |     |   |
| 6. Equipment and tooling are cleaned and returned to its correct location | ✓         |    |     |   |
| <b>Documentation:</b>   |           |    |     |   |
| Take picture if needed  |           |    |     |   |



General Comments

Three horizontal lines for general comments.

RESULT: **COMPETENT**  **NOT YET COMPETENT**  (please check (N))

Student: Aloysius Chakasi 9/1/2026

Signature: 

Assessor: Syhanza TD 2/1/2026

Signature: 

Supervisor: \_\_\_\_\_ Date: \_\_\_\_\_ Signature: \_\_\_\_\_

Data Recorded: \_\_\_\_\_ Date: \_\_\_\_\_ Signature: \_\_\_\_\_

365-3456 DIFFERENTIAL & BEVEL GEAR GP  
S/N LFJ1-UP  
PART OF 370-9013 AXLE GP-FRONT

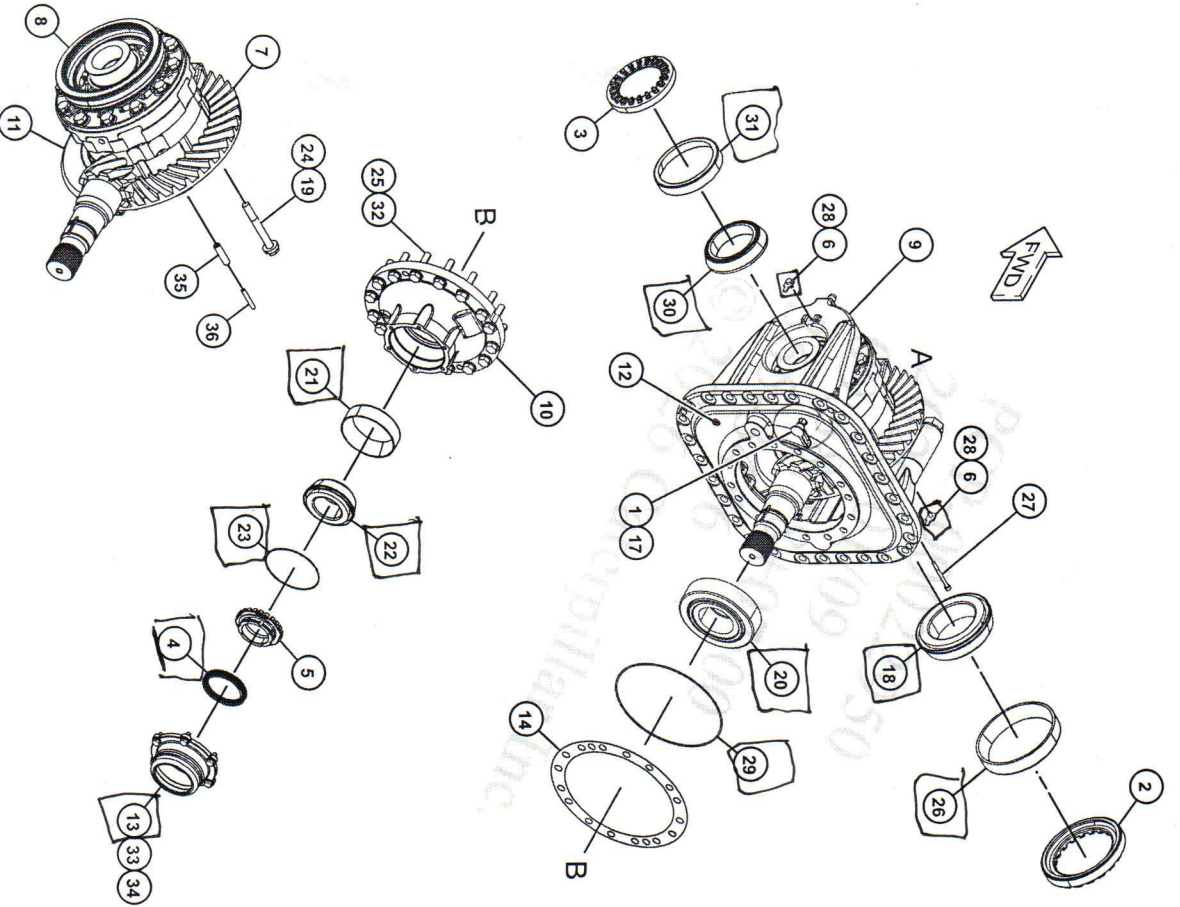

VIEW OF AREA  
(PARTS REMOVED FOR CLARITY  
AND EXPLODED)

| Image # | Callout # | Part Number     | Part Name                            | Quantity | Image # | Callout #      | Part Number                                | Part Name | Quantity |
|---------|-----------|-----------------|--------------------------------------|----------|---------|----------------|--|-----------|----------|
|         |           | Part List Items |                                      |          |         |                |  |           |          |
| 1       | RRP       | 6V-0852         | Cap-Dust                             | 1        | 19      | 235-8810       | Bolt<br>(M16X2X140-<br>MM)                 | 16        |          |
| 2       |           | 8R-2861         | Ring-<br>Adjustment                  | 1        | 20      | 271-9098       | Bearing AS-<br>Tapered<br>Roller           | 1         |          |
| 3       |           | 108-8369        | Ring-<br>Adjustment                  | 4        | 21      | 2D-9454        | Cup-Bearing                                | 1         |          |
| 4       | RRP       | 233-4503        | Seal-Lip Type                        | 1        | 22      | 2D-9455        | Cone-<br>Bearing                           | 1         |          |
| 5       | RRP       | 296-9950        | Locknut AS                           | 1        | 23      | 2P-1692        | Seal-O-Ring                                | 1         |          |
|         | RRP       | 5L-4753         | Ring-<br>Retaining                   | 1        | 24      | 317-1009       | Washer<br>(18X35X8-MM<br>THK)              | 16        |          |
| 6       |           | 297-3211        | Lock-Bearing                         | 2        | 25      | 5P-8247        | Washer-Hard<br>(17X32X3.5-<br>MM THK)      | 16        |          |
| 7       |           | 359-6216        | Self-Bevel<br>Gear                   | 1        | 26      | 6B-4370        | Cup-Bearing                                | 1         |          |
| 8       |           | 365-2063        | Differential<br>GP                   | 1        | 27      | 6V-5196        | Bolt-Socket<br>Head<br>(M8X1.25X80-<br>MM) | 4         |          |
| 9       | RRP       | 365-3451        | Carrier AS                           | 1        | 28      | 6V-8210        | Bolt<br>(M6X1.25X16-<br>MM)                | 2         |          |
|         | RRP       | 7V-9514         | Sleeve                               | 2        | 29      | 8J-8879        | Seal-O-Ring                                | 1         |          |
|         |           | 7X-2586<br>(M)  | Bolt<br>(M30X3.5X180-<br>MM)         | 2        | 30      | 8S-9075        | Cone-<br>Bearing                           | 1         |          |
|         |           | 9X-8399         | Washer<br>(33X55X6-MM<br>THK)        | 2        | 31      | 8S-9076        | Cup-Bearing                                | 1         |          |
|         |           | 157-7240        | Dowel                                | 2        | 32      | 8T-0357<br>(M) | Bolt<br>(M16X2X70-<br>MM)                  | 16        |          |
|         |           | 365-3453        | Housing-<br>Pinion                   | 1        | 33      | 8T-4121        | Washer-Hard<br>(11X21X2.5-<br>MM THK)      | 6         |          |
|         |           | 367-5433        | Shroud                               | 1        | 34      | 8T-4136<br>(M) | Bolt<br>(M10X1.5X25-<br>MM)                | 6         |          |
|         |           | 367-6002        | Plug AS                              | 1        | 35      | 9X-2619        | Pin-Spring                                 | 8         |          |
|         | RRP       | 3J-7354         | Seal-O-Ring                          | 1        | 36      | 9X-2620        | Pin-Spring                                 | 8         |          |
|         |           | 360-3677        | Plug<br>(7/16-20-THD)                | 1        |         |                |  |           |          |
|         |           | 368-5693        | Retainer-Seal                        | 1        |         |                |  |           |          |
|         | RRP       | 369-6615        | Shim Pack<br>(Includes 14-<br>SHIMS) | 1        |         |                |  |           |          |
|         |           | 110-6349        | Fitting AS<br>(Quick-<br>Disconnect) | 1        |         |                |  |           |          |
|         | RRP       | 1L-7518         | Cone-<br>Bearing                     | 1        |         |                |  |           |          |

M - Metric Part

SHIM PACK

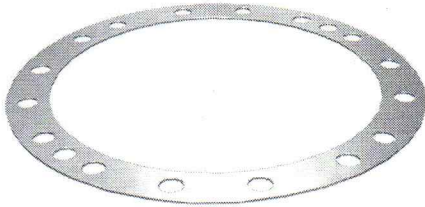

TAPERED ROLLER



SEAL LIP TYPE

